

# Southwest Calgary Ring Road

## Protecting the Beaver Pond (Wetland 6)

### Building the Green Wall

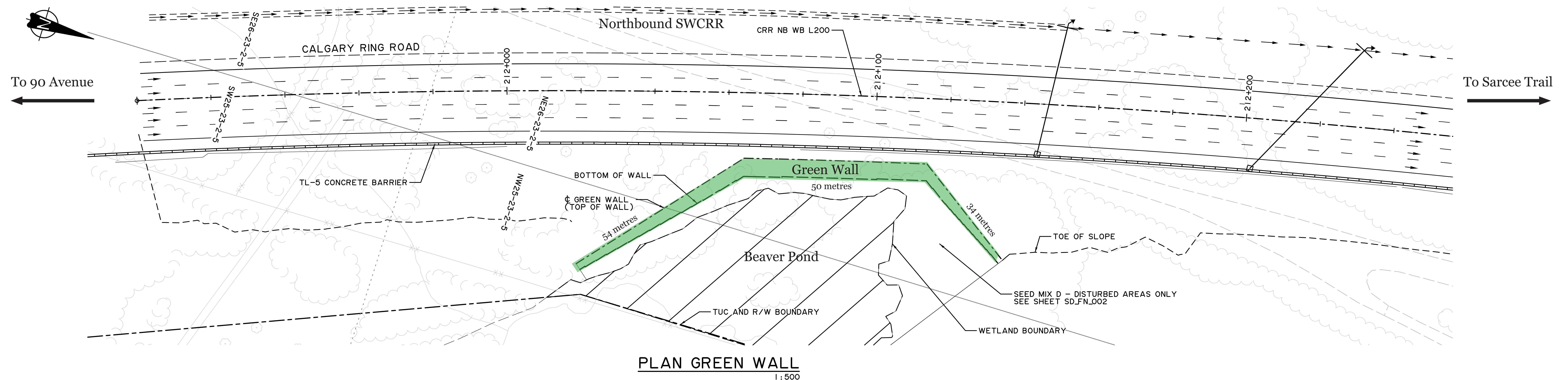

### Water Monitoring Program

- The SWCRR design avoids impacts on the Beaver Pond
- A green wall with local vegetation will create a natural barrier between the SWCRR and pond
- Effective sediment control measures in place to protect the pond throughout the construction period
- Natural drainage has been maintained to provide flows to the pond
- Monitoring program developed to ensure the quantity and quality of water to the Beaver Pond
- Monitoring data and an annual report is posted on the project website at [www.SWCRRproject.com](http://www.SWCRRproject.com)
- The monitoring program will continue throughout the construction period and for five years after construction

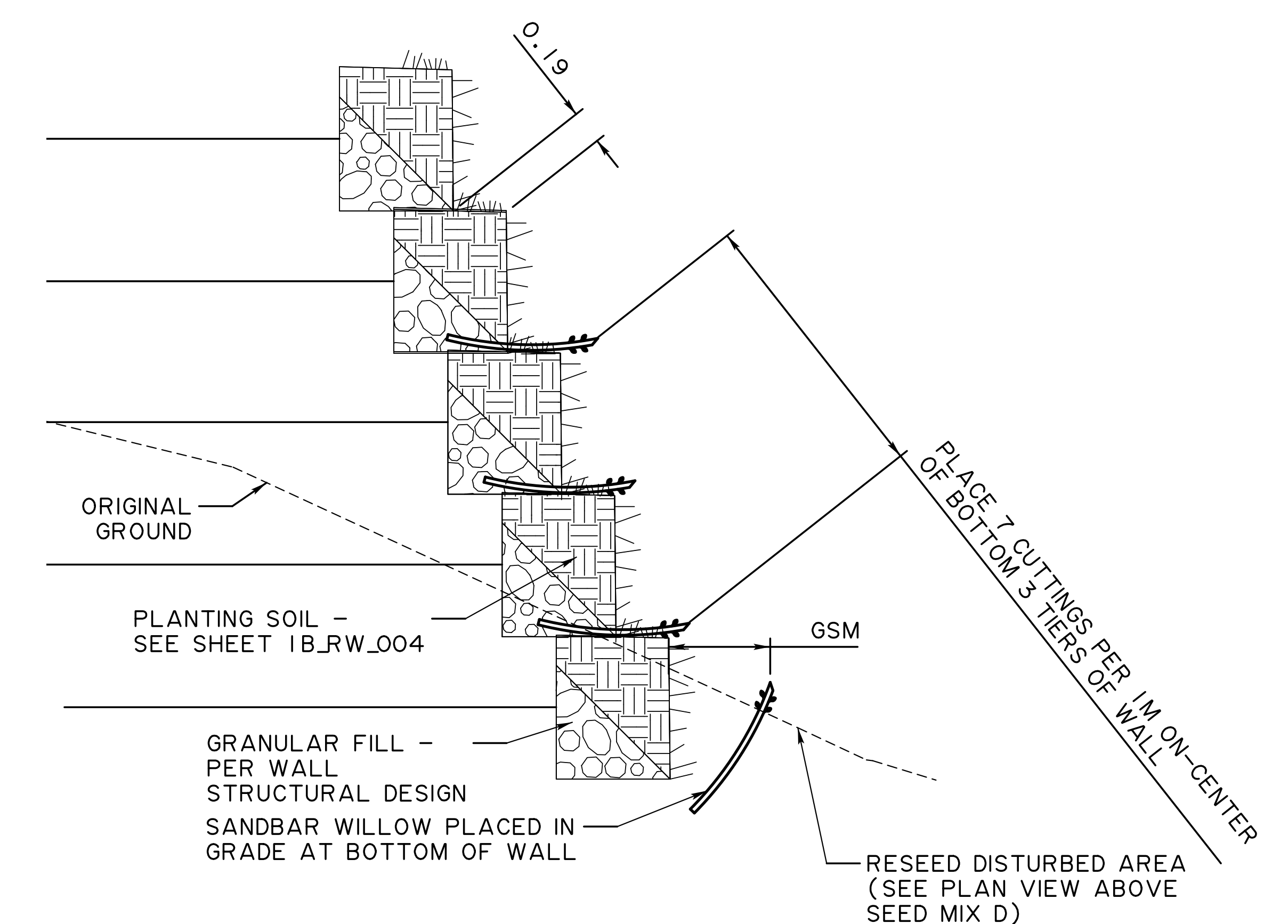
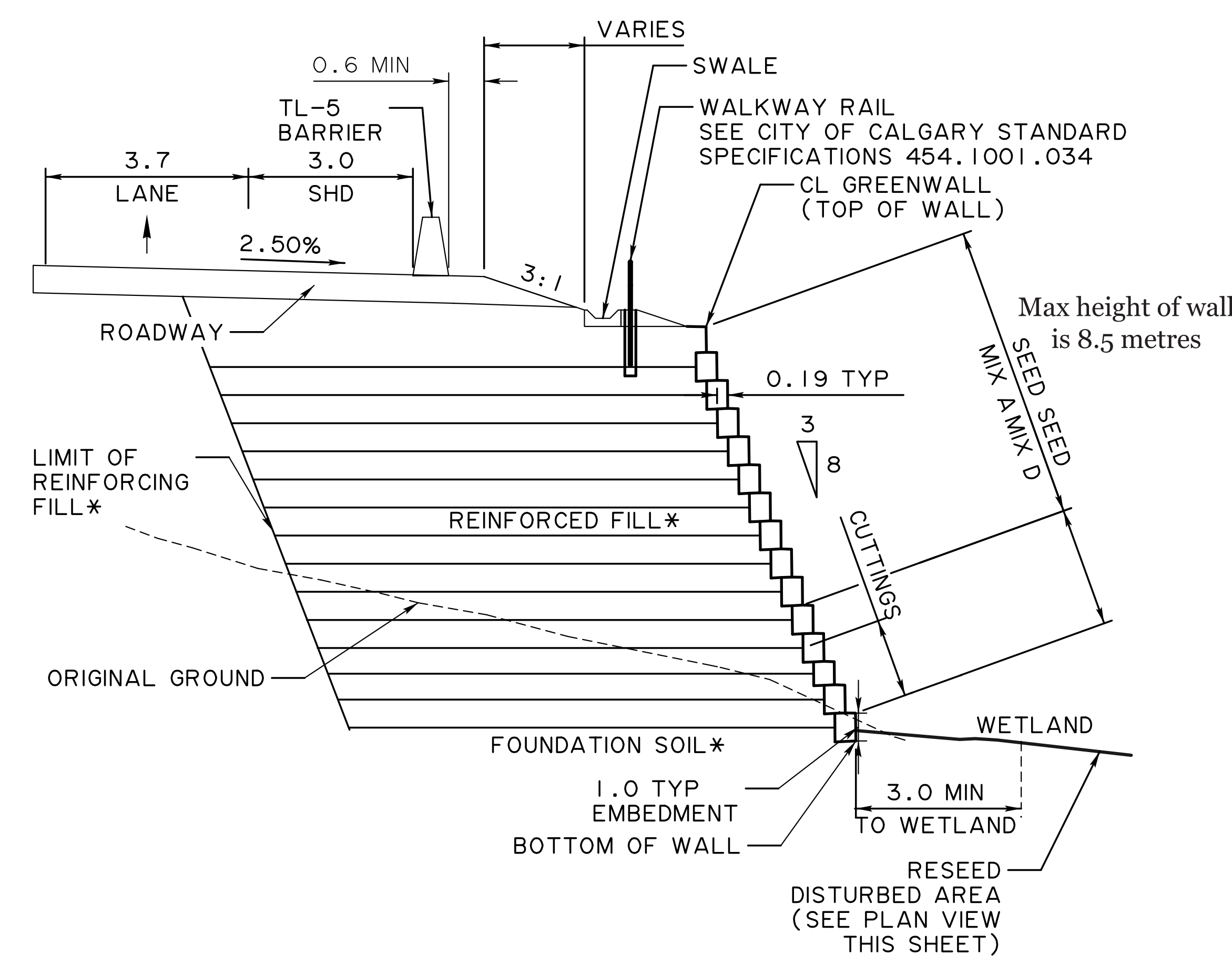

For discussion purposes only – subject to change

Questions? Contact us:

24/7 phone: 403-212-0565

[info@SWCRRproject.com](mailto:info@SWCRRproject.com)

[SWCRRproject.com](http://SWCRRproject.com)

